

# TUCSON



# Step in, Stand out.

The all-new Tucson signals the start of a new day, and a new way of driving. Rejecting the ordinary, the all-new Tucson pushes the boundaries of the segment to reinvent just about everything. Outside, Tucson is designed to impress while inside, you'll discover a level of roominess, comfort and versatility that exceeds all expectations.



# Step in, Stand out.

The all-new Tucson signals the start of a new day, and a new way of driving. Rejecting the ordinary, the all-new Tucson pushes the boundaries of the segment to reinvent just about everything. Outside, Tucson is designed to impress while inside, you'll discover a level of roominess, comfort and versatility that exceeds all expectations.





# Design that's thrilling and timeless.

With its 3D parametric-style grille and jewel-like surfaces, Tucson is for trendsetters with a taste for futuristic design. Adopting a daring new design language we call Sensuous Sportiness and created with cutting-edge digital design tools, Tucson stands out with its concealed daytime running lights, angulated wheel arches, and contrast side cladding.







# Experience that open feeling.

A feeling of openness welcomes you the moment you step into Tucson's cabin. The open-type cluster is a major innovation in design that establishes a premium, high-tech atmosphere that makes you feel safe, relaxed, and confident. Hidden out of sight, the innovative multi-air mode system diffuses cold or warm air gently and indirectly so it's not as harsh on your skin.

Full-touch center fascia (Personalized profiles)



10.25" open cluster



Multi air vent





# Live for the moment.

Whether it's a solo adventure or a long weekend excursion with the entire family, Tucson offers you exceptional versatility like the rear seat folding feature that provides 1,903 litres of flat storage space. The passenger space is equally accommodating with abundant amounts of room to keep everyone seated comfortably.



# Your digital journey starts here.

Whatever the journey, time seems to fly by when you have a reliable travel companion along for the ride like Tucson's 10.25-in infotainment system and the premium speakers from Bose. The touchscreen is easy to operate and synchs effortlessly with your smartphone to provide you with endless entertainment and information while on the road. And with Smart Cruise Control, highway driving is a lot more convenient.

10.25" LCD touchscreen



Bose premium audio



Smart Cruise Control





# You set the tempo.

Press the accelerator pedal and your pulse rate quickens as Tucson responds with a surge of smooth, quiet power made possible by Smartstream, Hyundai's latest engine technology. You have a choice of three types of engines and for a nice high tech touch, push button gear selection is now a standard feature across the entire model range.

## Smartstream engines

Gasoline 2.0	Gasoline 1.6T-GDi	Diesel 2.0
156 <small>Maximum Power ps/6,200 rpm</small>	180 <small>Maximum Power ps/5,500 rpm</small>	186 <small>Maximum Power ps/4,000 rpm</small>
19.6 <small>Maximum Torque kg-m/4,500 rpm</small>	27.0 <small>Maximum Torque kg-m/1,500-4,500 rpm</small>	42.5 <small>Maximum Torque kg-m/2,000-2,750 rpm</small>



# Ready for anything.

Tucson has serious SUV credentials, starting with HTRAC, an all-wheel drive system that gives you the confidence to tackle the most challenging driving conditions. Snow, mud, and sand will slow you down, but Tucson's specially-calibrated Terrain mode will keep you moving.



## HTRAC All-Wheel Drive

When the weather takes a turn for the worse, HTRAC keeps you moving. The heart of this all-wheel drive system is an advanced electronic controller that continuously analyzes your speed and road conditions. It automatically optimizes torque distribution among the four wheels and will apply the brakes, if necessary, to ensure maximum traction and directional stability when the going gets rough.



## Terrain Mode

With a quick flick of the switch, you can adjust the powertrain to suit challenging road and weather conditions: SNOW, MUD and SAND settings ensure you are getting maximum traction when the going gets really rough.

\*Applies only to Smartstream Diesel 2.0 engine.

## Drive Mode

With Drive mode, you get to pick the style suits you best: NORMAL is for relaxed everyday driving while ECO gives you optimal fuel efficiency. SPORT is for quicker acceleration, and SMART automatically adjusts gear shift intervals based on an analysis of your recent driving patterns.



# Hyundai SmartSense

## Forward Collision-Avoidance Assist (FCA, Junction Turning)

FCA capabilities have been expanded to include Junction Turning function. While driving if there is a risk of collision with an oncoming vehicle while turning left at an intersection, the function automatically assists with emergency braking.



## Blind-Spot Collision-Avoidance Assist (BCA)

BCA uses rear corner radar to monitor both of your blind spots. If a vehicle is detected in the blind spot while the turn signal is flashing, BCA will automatically apply differential braking during your attempted lane change thus helping you avoid an unsafe lane change and a potential collision.

## Blind-Spot View Monitor (BVM)

When the turn signals are activated, the rear-side image of the corresponding direction is displayed in the cluster.



## Lane Following Assist (LFA)

LFA keep you centered within the lane using its front view camera to monitor lane markers.

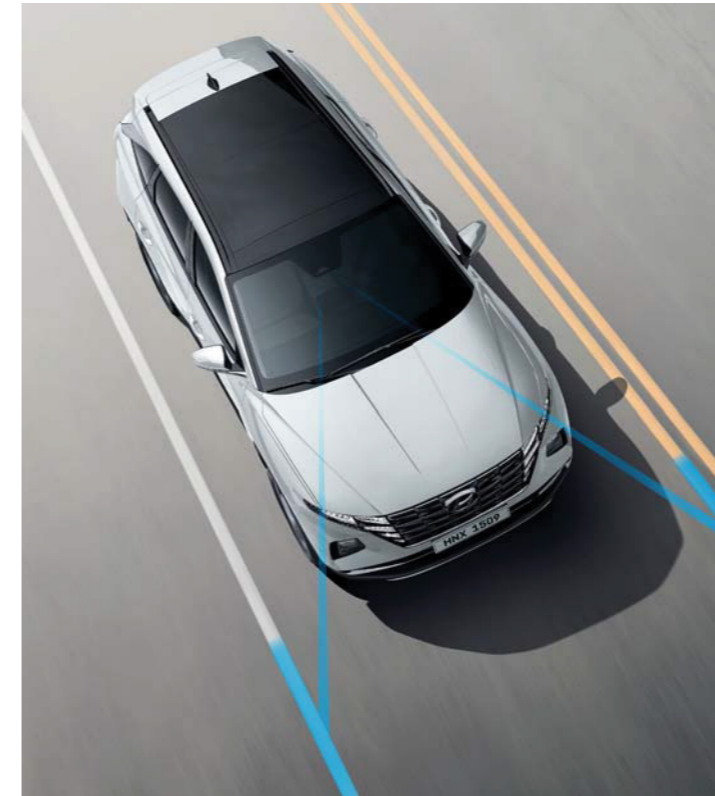

## Smart Cruise Control (SCC)

SCC maintains the set speed while keeping a set distance away from the vehicle ahead without ever requiring any additional inputs from the driver.

## Rear Cross-Traffic Collision-Avoidance Assist (RCCA)

When backing out, RCCA warns the driver to the approach of a vehicle crossing his rearward path; if necessary, the emergency braking is automatically applied to avoid a collision.

## Forward/Reverse Parking Distance Warning (PDW)

If your car is too close with obstacle, PDW warns you by using ultrasonic sensors in the front and rear bumpers. So you can avoid scratches and park safely.





# Drive the game-changer.

Whatever the challenge each new day brings, you will be ready to face them confidently when you're driving a game-changer like the all-new Tucson. You get solid engineering, an iconic style and high-technology features that are highly engaging and that make your day a whole lot easier.

# Features



Projection headlamps (Standard)



MFR LED headlamps (Optional)



Silver paint radiator grille



Dark black chrome radiator grille



Outside mirror LED repeaters (Optional)



Rear combination lamps (Standard)



LED rear combination lamps (Optional)



Chrome-coated beltline molding



Smart tailgate system



Panoramic sunroof



17" Steel Wheels



17" Alloy Wheels



18" Alloy Wheels



19" Alloy Wheels



4.2" TFT LCD Supervision cluster



3.8" Standard audio system



Manual air conditioning system



Full auto air conditioning system



Integrated memory system (IMS)



Shift-by-wire automatic transmission (Optional)



Ventilated front seats



Mood lamp



Walk-in device



Heated front seats

# Interior colors



Black interior



Gray interior



Blue interior



Brown interior

# Exterior colors

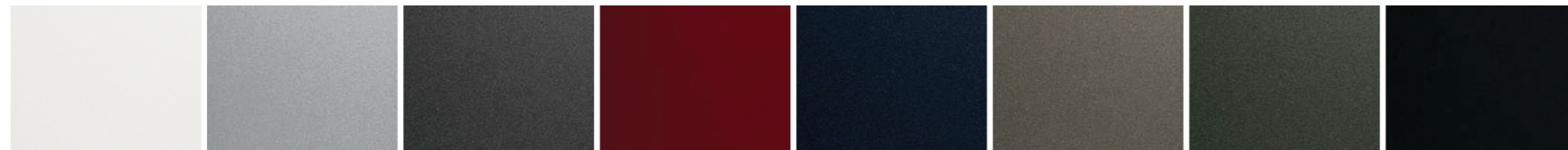

White Cream    Shimmering Silver    Titan Gray    Crimson Red    Deep Sea    Silky Bronze    Amazon Gray    Phantom Black

# Specifications

Type	TUCSON		
	Smartstream G2.0	Smartstream G1.6T-GDI	Smartstream D2.0
Engine type	4-Cylinders DOHC	4-Cylinders DOHC	4-Cylinders DOHC
Displacement (cc)	1,999	1,598	1,998
Max. Power (ps / rpm)	156 / 6,200	180 / 5,500	186 / 4,000
Max. Torque (kg-m / rpm)	19.6 / 4,500	27.0 / 1,500-4,500	42.5 / 2,000-2,750
<b>Brakes</b>			
Front	Ventilated discs		
Rear	Solid discs		
<b>Suspension</b>			
Front	MacPherson Strut		
Rear	Multi-Link		
<b>Tire</b>	235/65R17, 235/60R18, 235/55R19		
<b>Dimensions</b>			
Head Room (mm)	Front (w/Sunroof) / Rear (w/Sunroof)	1,019 (968) / 1,002 (990)	
Leg Room (mm)	Front / Rear	1,052 / 1,050	
Shoulder Room (mm)	Front / Rear	1,464 / 1,422	

- The above values are results from internal testing and are subject to change after validation.
- Some of the equipment illustrated or described in this catalog may not be supplied as standard equipment and may be available at extra cost.
- Hyundai Motor Company reserves the right to change specifications and equipment without prior notice.
- The color plates shown may vary slightly from the actual colors due to the limitations of the printing process.
- Please consult your dealer for full information and availability on colors and trims.



Overall Width 1,865  
Wheel Tread\* 1,615



Overall Length 4,630  
Wheel Base 2,755

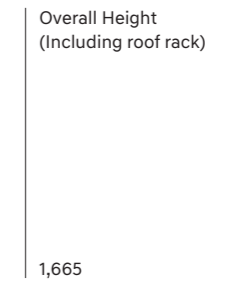

Wheel Tread\* 1,622

Unit : mm \* Wheel tread • 17" Wheel (Front/Rear) : 1,620/1,627 • 18" Wheel (Front/Rear) : 1,615/1,622 • 19" Wheel (Front/Rear) : 1,615/1,622



## **YETI MOTORS LTD**

An Astro Holdings Enterprise

### **Lusaka - Lumumba Road Lusaka**

General enquiries: 0211 225 896 / Sales: 0974 235 490

Service & parts : 0975 385 357

E: sales@yetimotors.com / service@yetimotors.com

### **Copperbelt - Chibuluma Road Kitwe**

General enquiries: 0212 211 096 / Sales: 0971 471 227

Service & parts : 0979 854 500

E: gm.copperbelt@astroholdings.co.zm